

Steering Column

Inspection

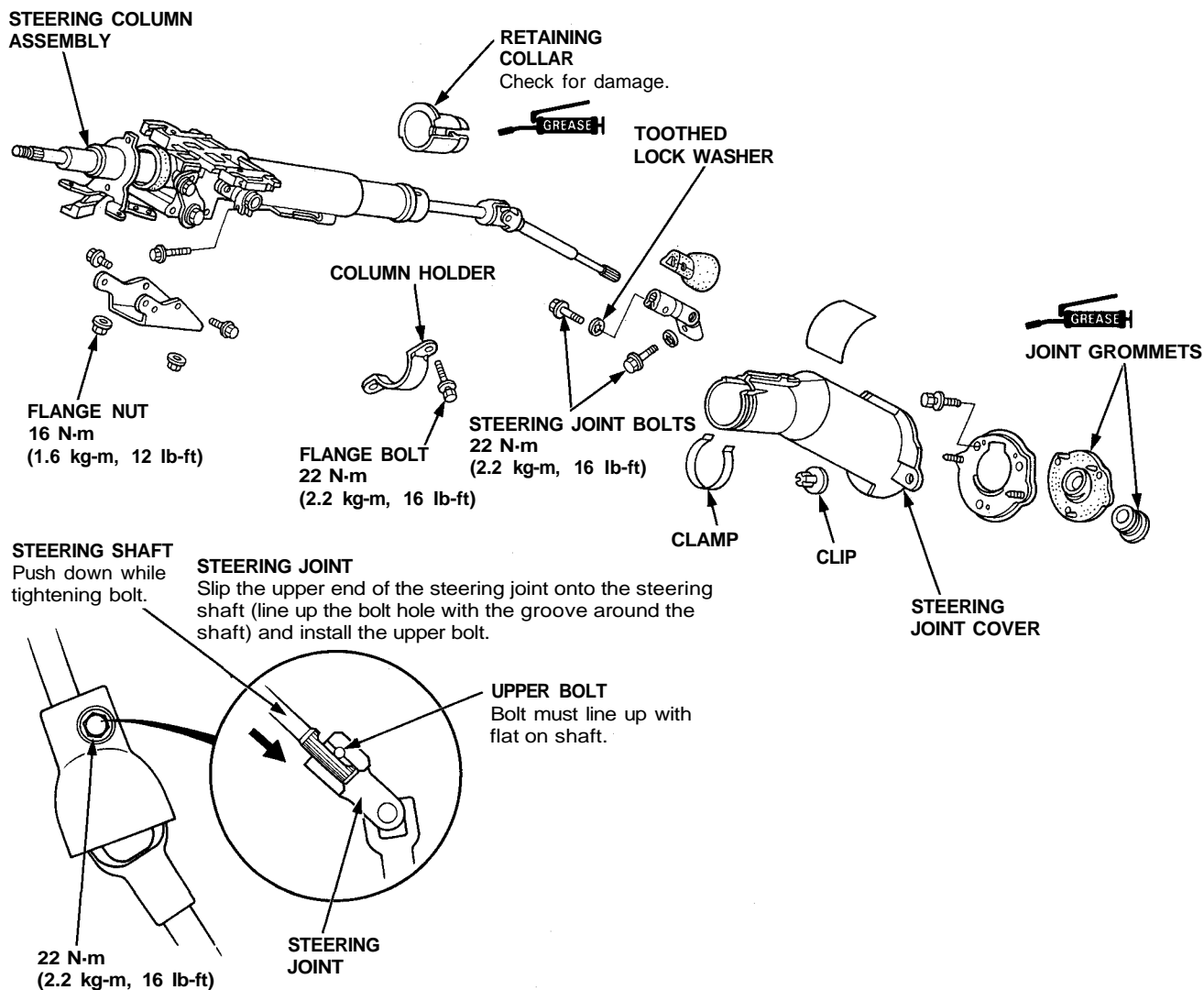

NOTE:

- Check the telescopic mechanism and steering joint bearings or steering shaft for movement and damage. Replace as an assembly if damaged or faulty.

Attach a spring scale to the knob of the telescopic lever.
Measure the force required to move the lever.

Preload: 30–60 N (3–6 kg, 6.6–13.2 lbs)

If the force measured is not within the specification, loosen the lockbolt then the stopper until the correct force can be obtained.

